

Registration Information*Location: South Foyer (LEVEL 3)*

Monday, September 21 7:00am-9:00am

Location: Paca Room (LEVEL 3)

Tuesday, September 22 - Friday, September 25 8:00am-5:00pm

Internet Café*Location: South Foyer (LEVEL 3)*

Monday, September 21 Opens at noon

Tuesday, September 22 - Friday, September 25 Open 24 hours

Saturday, September 26 Closes at 2:00pm

Course Breaks

7:00am-9:00am – Morning Coffee

10:30am-10:50am – Morning Break

12:15pm-1:30pm – Lunch (on your own)

3:00pm-3:20pm – Afternoon Break

Class Information*All courses will run 9:00am-5:00pm (unless noted).***SEC401: Security Essentials Bootcamp Style**

Instructor: Paul A. Henry Location: Tubman A/B (LEVEL 3)

*Bootcamp Hours: 5:00pm-7:00pm (Course days 1-5)***SEC503: Intrusion Detection In-Depth**

Instructor: Jonathan Ham Location: Ruth (LEVEL 1)

SEC504: Hacker Tools, Techniques, Exploits, and Incident Handling

Instructor: Bryce Galbraith Location: Johnson A/B (LEVEL 1)

*Extended Hours: 5:00pm-7:15pm (Course day 1)***FOR526: Memory Forensics In-Depth**

Instructor: Alissa Torres Location: Carroll A/B (LEVEL 3)

Special Events*All special events are located on LEVEL 3 (unless noted).*

SPECIAL EVENT

Welcome to SANS – General Session

Speaker: Jonathan Ham

Mon, Sept 21 | 8:15am-8:45am | Location: Carroll A/B

KEYNOTE

Evolving Threats & Defenses

Speaker: Paul A. Henry

Mon, Sept 21 | 7:15pm-9:15pm | Location: Carroll A/B

SANS@NIGHT

How to Bring Some Advanced Persistent Trickery to Your Fight Against Advanced Persistent Threats

Speaker: Bryce Galbraith

Tue, Sept 22 | 7:15pm-8:15pm | Location: Carroll A/B

LUNCH & LEARN

Presented by:



Wed, Sept 23 | 12:15pm - 1:15pm | Location: Ruth (LEVEL 1)

SANS@NIGHT

The Plinko Board of Modern Persistence Techniques

Speaker: Alissa Torres

Thu, Sept 24 | 7:15pm-8:15pm | Location: Carroll A/B

Interested in adding a GIAC Certification or an OnDemand Bundle?

To receive the discounted rate, you must sign up before Monday, September 28th at 8:00pm EDT

Call or e-mail SANS Registration:

1.301.654.SANS(7267)

| registration@sans.org |

ondemand@sans.org

Hilton Baltimore – Floorplan

LEVEL I

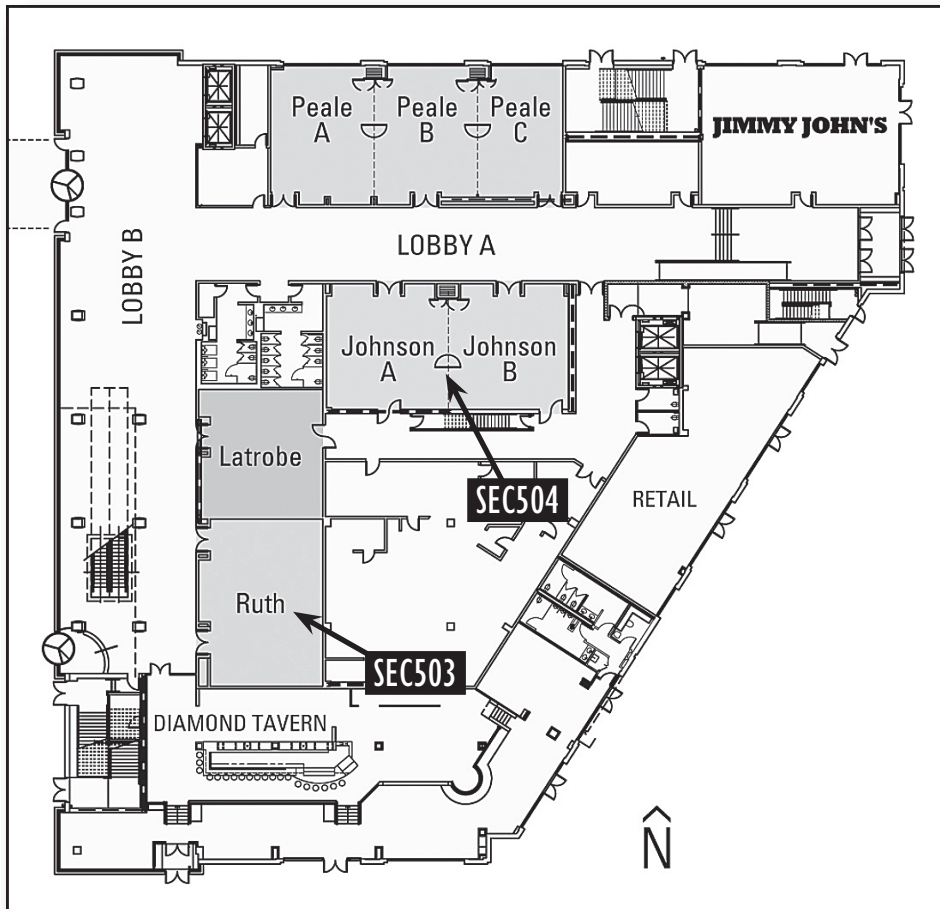

LEVEL 3

PRATT STREET

